

BOARDMAN SCHOOL SITE PLAN

SCALE: 1" = 30'-0"

8-9-2023





**BOARDMAN SCHOOL
LOWER LEVEL FLOOR PLAN**
SCALE: 1/16" = 1'-0"

HABITABLE SQUARE FOOTAGE:
LOWER LEVEL REHAB AREA = 6,300 S.F.
TOTAL BUILDING SELLABLE UNITS = 24,510

8-9-2023



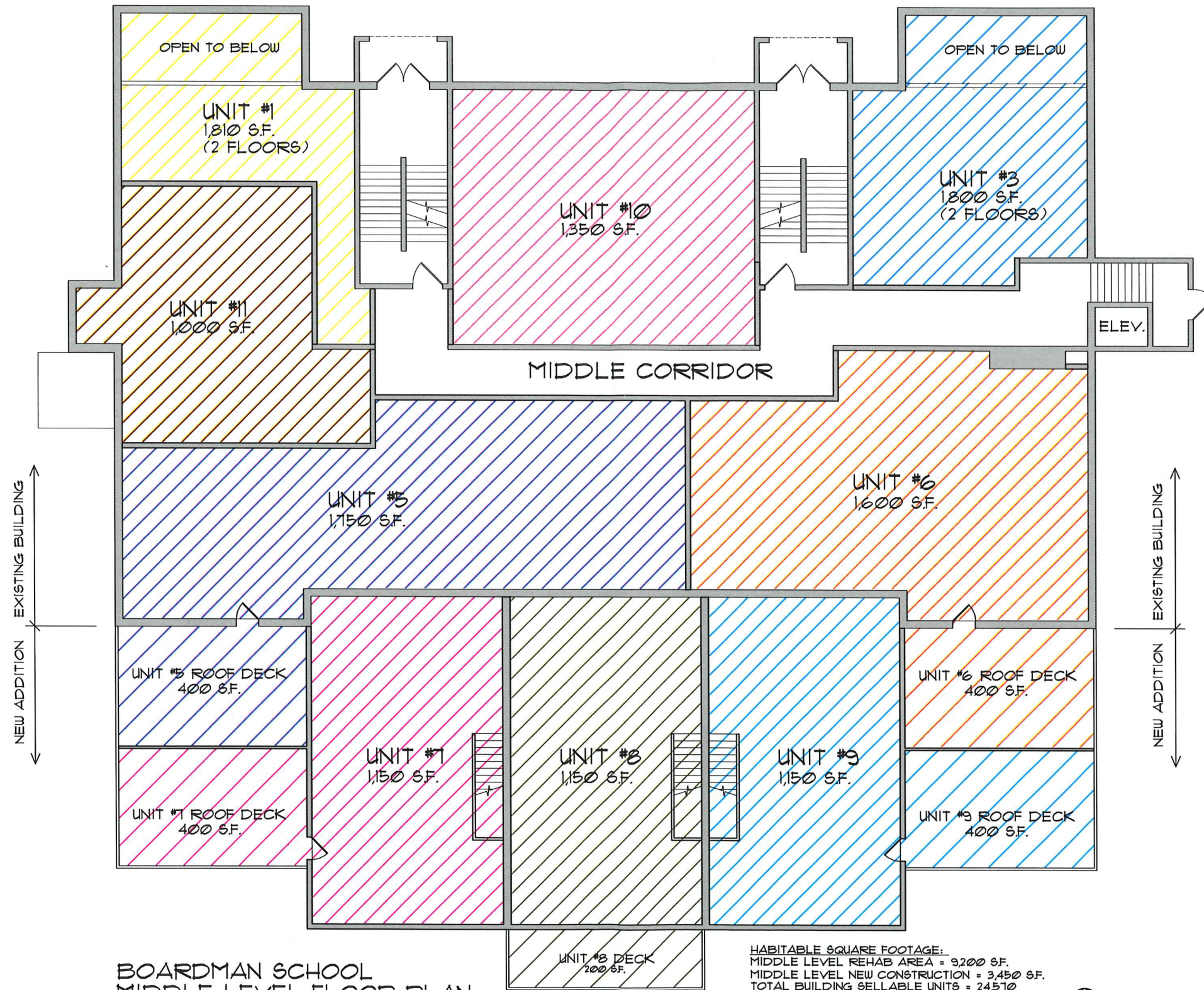

**BOARDMAN SCHOOL
MIDDLE LEVEL FLOOR PLAN**
SCALE: 1/16" = 1'-0"

8-9-2023





BOARDMAN SCHOOL
UPPER LEVEL FLOOR PLAN
SCALE: 1/16" = 1'-0"

HABITABLE SQUARE FOOTAGE:
UPPER LEVEL REHAB AREA = 9,200 S.F.
TOTAL BUILDING SELLABLE UNITS = 24,510