



TCAPS Montessori

Parent Questions & Answers
Virtual Meeting Recap from May 21, 2020

Parking Lot:

PARENT QUESTION: One really great aspect of the current school's design is that during drop-off and pick-up, so many families are out of their cars, mingling with one another, which really helps maintain a sense of community. These casual moments that bond the community together require no planning or extra work; they just happen because of how drop-off and pick-up are designed. The new plan seems very car-focused for drop-off and pick-up. Once we have a vaccine for COVID-19 and we are all able to congregate again, what measures can you take to help maintain or create new opportunities for casual moments of social glue on the campus?

RESPONSE: Parents have the option to park in the lot versus using the drop off lane. We hope these interactions will occur naturally as they have at our current site.

PARENT QUESTION: The design shows an excessive amount of parking. The design states 90 parking spots but cars can easily park at the drop off lines too so in reality there are well over 100 parking spots. Why do we need this much parking? There appears to be more of a pavement footprint than a building footprint. Do cars really need more space than our kids? Could the middle school auxiliary parking be utilized? This parking lot is nearly always empty during school hours and only a short walk away. There is already a maintained path from it to the new school. Could we partner with Meijer to use their side parking lot on a limited basis.

RESPONSE: The current drawing is still in draft form. However, approximately 50 spaces are needed for staff parking. We also need to efficiently design the space now for future opportunities and growth.

PARENT QUESTION: Can you please identify how many cars are in the drop line? It appears to be perhaps 40-50? Is the sole purpose of the northwest loop to facilitate the car line?

RESPONSE: Currently the design shows 60 spaces in the larger drop off lane and 10 in the shorter one on the south side. The northwest loop is designed to lengthen the drop off loop.

PARENT QUESTION: Could the parking lot become an impervious surface to allow for water to be slowed down on its way to the wetlands?

RESPONSE: There are a lot of options being considered in this early stage of design. Our landscape architects will be working with the needs and requirements to make a recommendation for design of drainage.

Safe Biking & Walking:

(please see the next slide, map included)

PARENT QUESTION: How is the administration working with other local organizations and governmental officials to ensure families and students have safe opportunities to walk and ride their bicycles to and from school?

RESPONSE: We will be maintaining our relationship with local organizations as we work through this plan. We have been in contact with TART Trails and the Safe Routes to School group so that when the site plan has been developed and we get an address, more definitive conversations can occur. We are also working with the County Road Commission on a traffic study to determine location and number of entrances. Until we have the results from the study, all site plans remain strictly preliminary.

PARENT QUESTION: Division Street and Silver Lake Road are nasty boundaries separating the new campus from much of town. How is the administration working to make sure the new school campus remains connected to as many communities as possible and does not become an island that is (a) functionally isolated and (b) safely accessible only by car?

RESPONSE: Please see the response below, as it and the map on the next slide pertain to this question.

PARENT QUESTION: Are there plans to include a crosswalk at Franke Rd into the Meijer parking lot? There is a BATA bus pick up located there. My 13 year old already struggles to cross to the BATA stop after middle school because there is so much traffic at that time of day. (It usually takes him 10 minutes to cross. We have timed it on several occasions.) With the addition of the Montessori it will only get worse. I would love to utilize BATA for my Montessorian but only if there is a safe way to cross Franke Rd. I have spoken with county staff who state the school would need to fund such a crosswalk.

RESPONSE: This current plan is still in draft form, after the main entrance drive is approved and placed, we will continue to work with other entities in the next phase of design, which will include sidewalks, crosswalks, Buffalo Ridge Trail, etc.



- 1 GLENN LOOMIS
 - 2 WEST MIDDLE SCHOOL
 - 3 MONTESSORI SITE
 - 4 HISTORIC BARNs
 - 5 COMMONs
 - 6 YMCA
 - 7 GREAT WOLF LODGE
 - 8 COPPER RIDGE
- BUFFALO RIDGE TRAIL
 - EXISTING WALK / BIKE
 - PROPOSED SAFE ROUTES TO SCHOOL IMPROVEMENTS

MDOT IMPROVEMENTS ON DIVISION
14TH TO FRONT ST. SUMMER 2020 -
SPRING 2021. TRAFFIC CALMING,
PEDESTRIAN ISLANDS, TURN LANES



Outdoor Space:

PARENT QUESTION: The gardens were promoted as a major reason for moving the building site but seem an afterthought in the design. During the BOE presentation it was stated that the gardens would line the parking/drive and would be part of the wetland buffer. This seems like the worst possible location first because of runoff from the parking and all it's contaminants (oil, gas, sand, salt) and second for the safety of kids working in/near the parking area. The proposed greenhouse is not adequate without land to plant. When bids come back high and things need to be cut I'm confident the greenhouse will be the first thing on the chopping block.

RESPONSE: To be clear, in the Board presentation on May 14, it was not stated that the gardens would line the parking/drive and be part of the wetland buffer. It was indicated that we are allowed to plant in the 25 foot setback that we are honoring per the Watershed Center's request. We are too early in the design process to define the gardens. There are a lot of opportunities for those areas, we just haven't reached that point in the design yet. As a staff priority, we do have a greenhouse planned that will be able to extend the growing season. There will be a small group discussion in the fall specifically designing these areas which will include Lisa VanLoo, parents, students, the landscape architects, etc.

PARENT QUESTION: Can gardens be planted in the wetland buffer area?

RESPONSE: We are allowed to plant within the 25 foot buffer. Gardens can be many variations like a vegetated swale that is specifically designed to reduce runoff, and filter the water as it passes through. The landscape architects will work with the staff and students on the design.

PARENT QUESTION: What is the size of the playground?

RESPONSE: The current draft plan shows 13,000-15,000 total square feet for all playgrounds but hasn't been permanently defined yet. The middle school green space and track will be accessible to our students with the coordination of the West Middle School.

Floor Plans/Other:

PARENT QUESTION: Is there a library? Could you please identify it on the site plan.

RESPONSE: Yes, there is a library. It's a two-story space labeled Media Center on the floor plan.

PARENT QUESTION: Will there be a lot of windows in the cafeteria for natural light?

RESPONSE: Absolutely. We envision something similar to Eastern Elementary. A lot of windows with natural light but still planning for a secure pick-up and drop-off for Extended Day.

PARENT QUESTION: Could the orientation of the building be adjusted to allow for more south facing glass to help with solar heating?

RESPONSE: The architects are taking this into consideration.

PARENT QUESTION: Would classrooms release in the afternoon through the main front door, or through each classroom exterior door?

RESPONSE: This is undecided yet until we know what the pick up process will look like. There will be a specific process determined that will focus on student safety.

PARENT QUESTION: Will the middle school students have recess?

RESPONSE: The Adolescent program will follow the more traditional middle school alignment and will not have recess. They will have a 40 minute lunch period and relative to the curriculum will have planned "going outs" every Friday.

First Floor Plan:

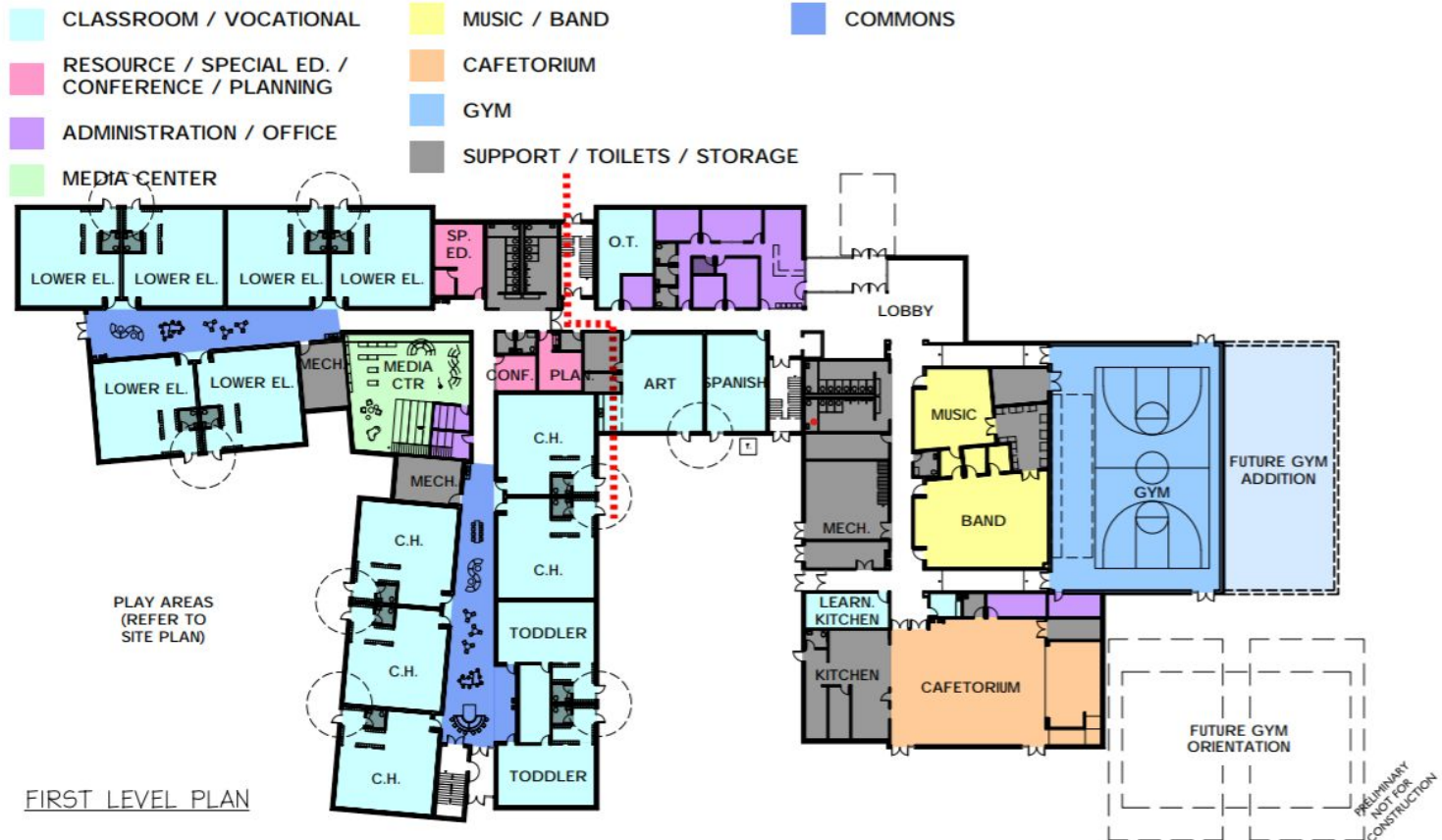

Second Floor Plan:

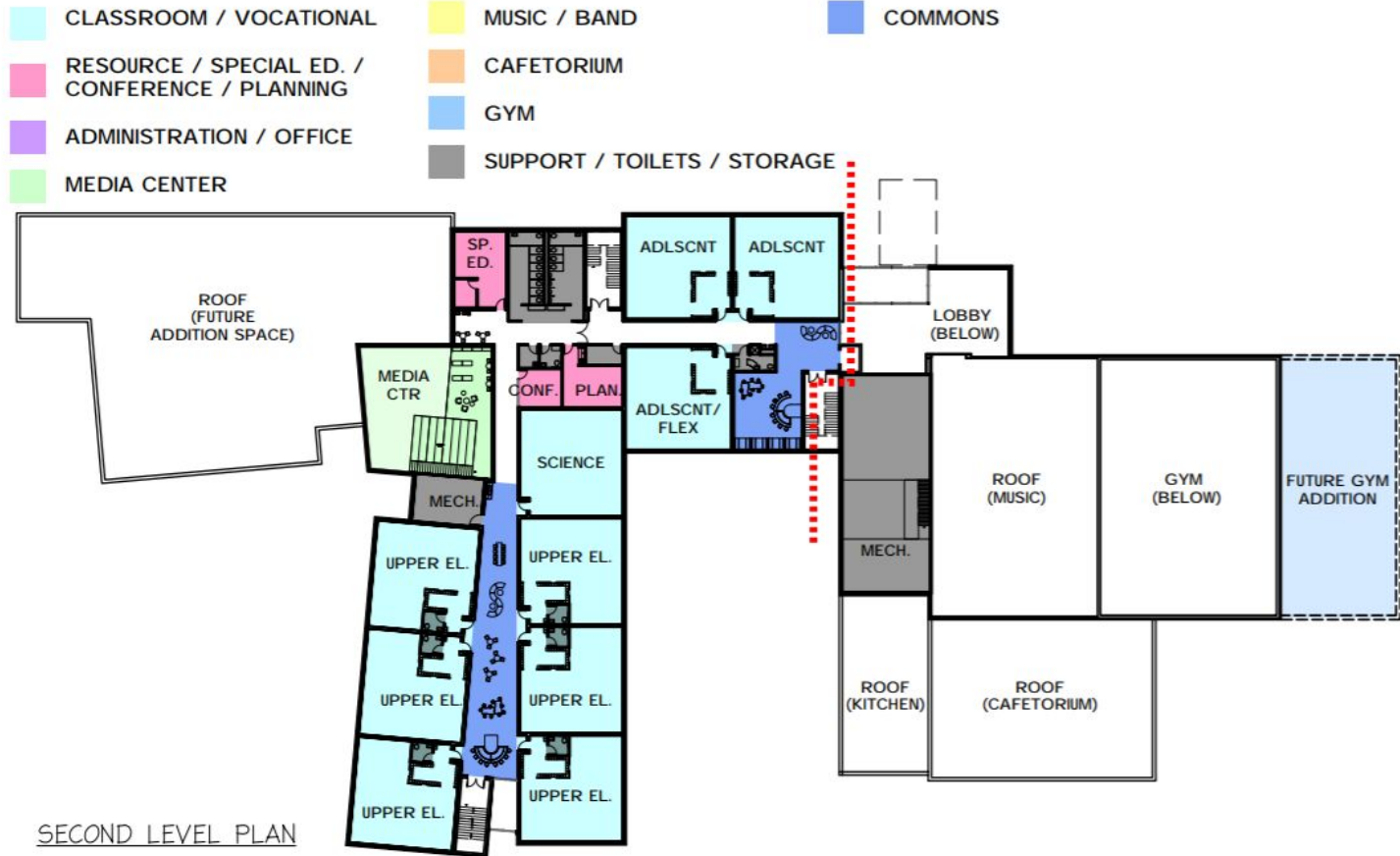

PRELIMINARY
NOT FOR
CONSTRUCTION